



DMG SpA
 Via Quarto Negroni, 10
 00040 CECCHINA (ROMA) • ITALIA
 Tel. +39 06930251 • Fax +39 0693025240
 info@dmg.it • www.dmg.it

Linea CAPRICE

COP
 LOP
 LIP



Istruzioni di montaggio
Fixing instructions • Fiche de montage
Montageanleitung • Instrucciones de montaje

4

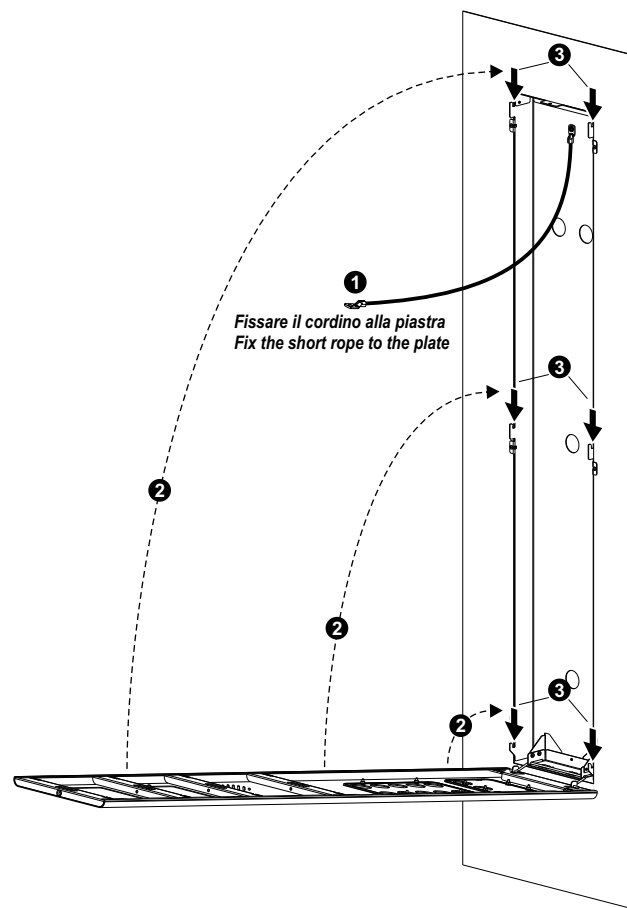

5

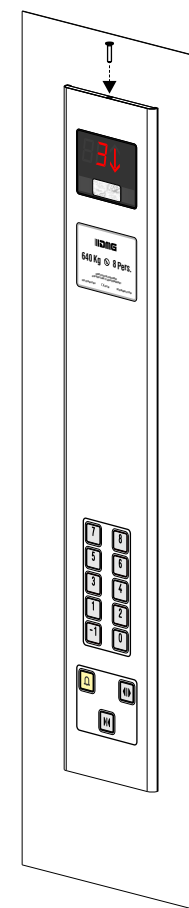

4) COP SHORT

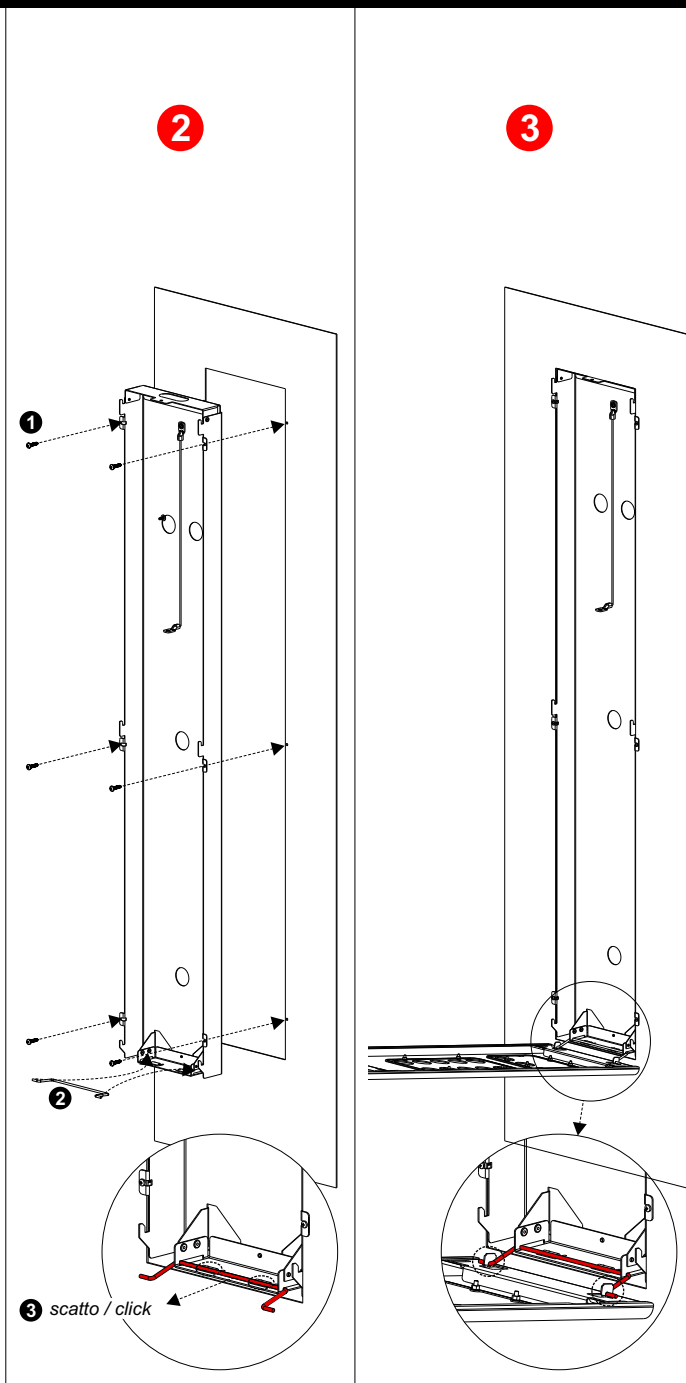
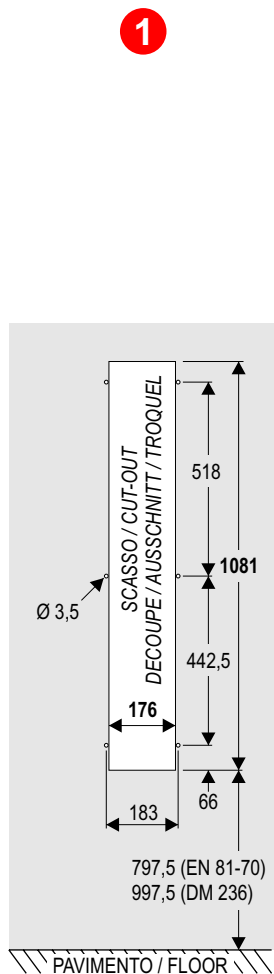

INDICE / INDEX

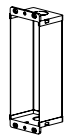
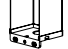
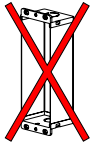
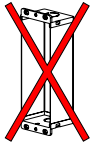
1) LOP LIP	FISSAGGIO A VITE SCREW FIXING / MONTAGE AVEC VIS BEFESTIGUNG MIT SCHRAUBEN / FIJACIÓN CON TORNILLO	Pg. 4
2) LOP LIP	FISSAGGIO NASCOSTO HIDDEN LOCK FIXING / FIXATION CACHÉE VERSTECKTE BEFESTIGUNG / FIJACIÓN ESCONDIDA	Pg. 6
2.1)	Scasso Cut-out / Decoupe Ausschnitt / Troquel	Pg. 6
2.2)	Tabella di riferimento foratura Table of reference holes / Tableau de forage Bohrungshinweise / Tabla de referencia de perforación	Pg. 7
2.3)	 Fissaggio su stipite Door frame fixing / Fixation sur montant de porte Befestigung auf Türzarge / Fijación en la jamba	Pg. 8
2.4)	 Fissaggio a muro Concrete wall fixing / Fixation au mur Befestigung an der Mauer / Fijación en la pared	Pg. 9
2.5)	 Fissaggio su stipite Door frame fixing / Fixation sur montant de porte Befestigung auf Türzarge / Fijación en la jamba	Pg. 10
2.6)	 Fissaggio a muro Concrete wall fixing / Fixation au mur Befestigung an der Mauer / Fijación en la pared	Pg. 11
2.7)	Smontaggio Dismantling / Demontage Abbau / Desmontaje	Pg. 11
3) COP LONG	Pg. 12
4) COP SHORT	Pg. 14

1) LOP-LIP FISSAGGIO A VITE / SCREW FIXING

← 70/90 → Scatola
Back box • Boîte
Frontplattenkasten • Caja

M4x25 A1
B
C
↓ ↑
3,9x16 A2

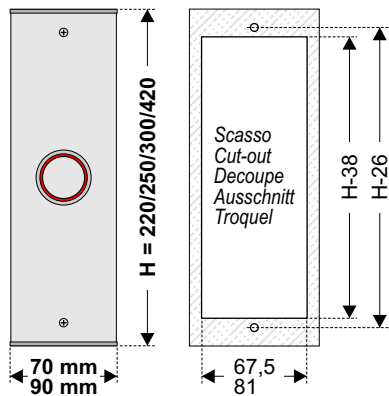

← 70 → Scatola
Back box • Boîte
Frontplattenkasten • Caja

A
4x40 B1
4x40 D1
Ø 6 C
↓ ↑
4,2x13 B2
3,9x16 D2

Fissaggio a muro
Concrete wall fixing
Fixation au mur
Befestigung an der Mauer
Fijación en la pared

Fissaggio su stipite
Door frame fixing
Fixation sur montant de porte
Befestigung auf Türzarge
Fijación en la jamba

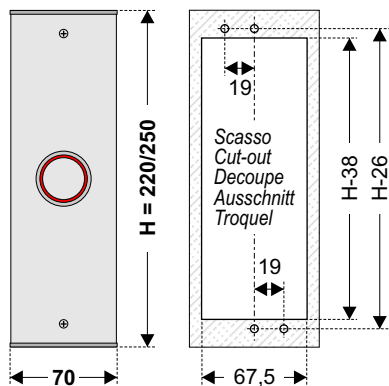

← 90 → Scatola
Back box • Boîte
Frontplattenkasten • Caja

A
4x25 B

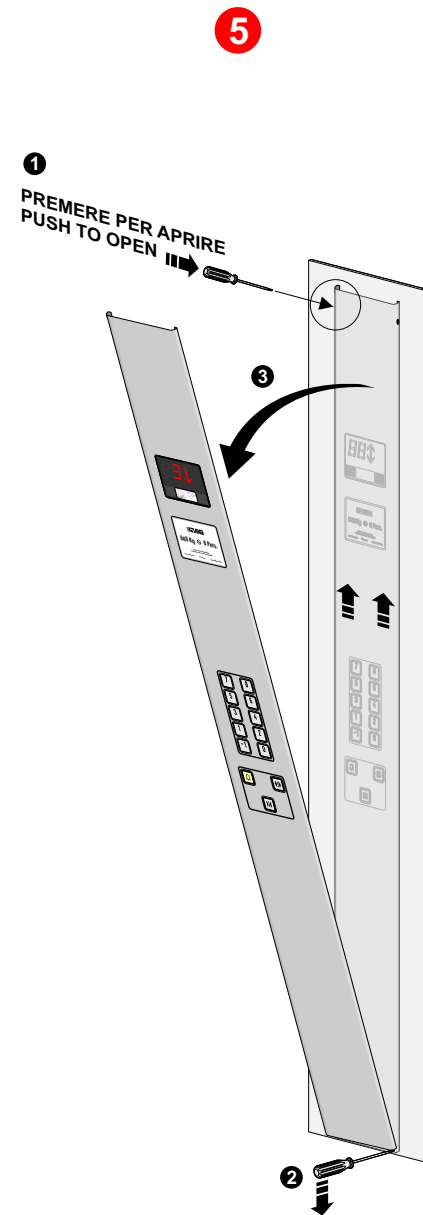
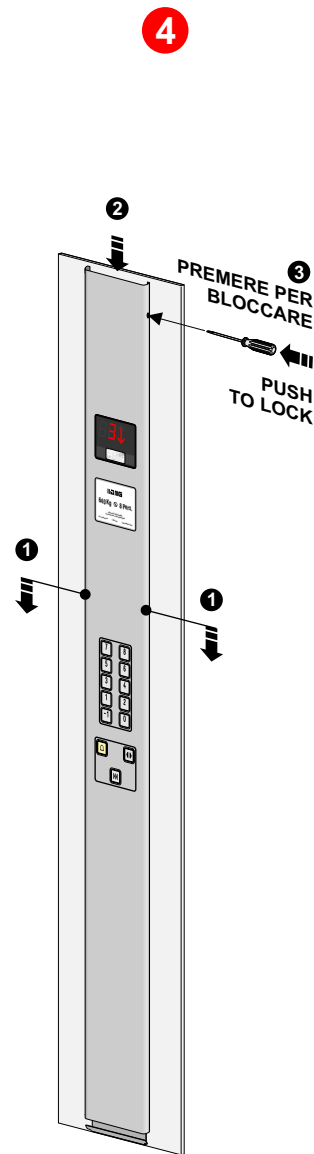
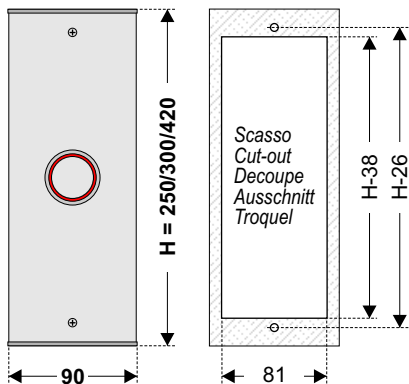

3) COP LONG

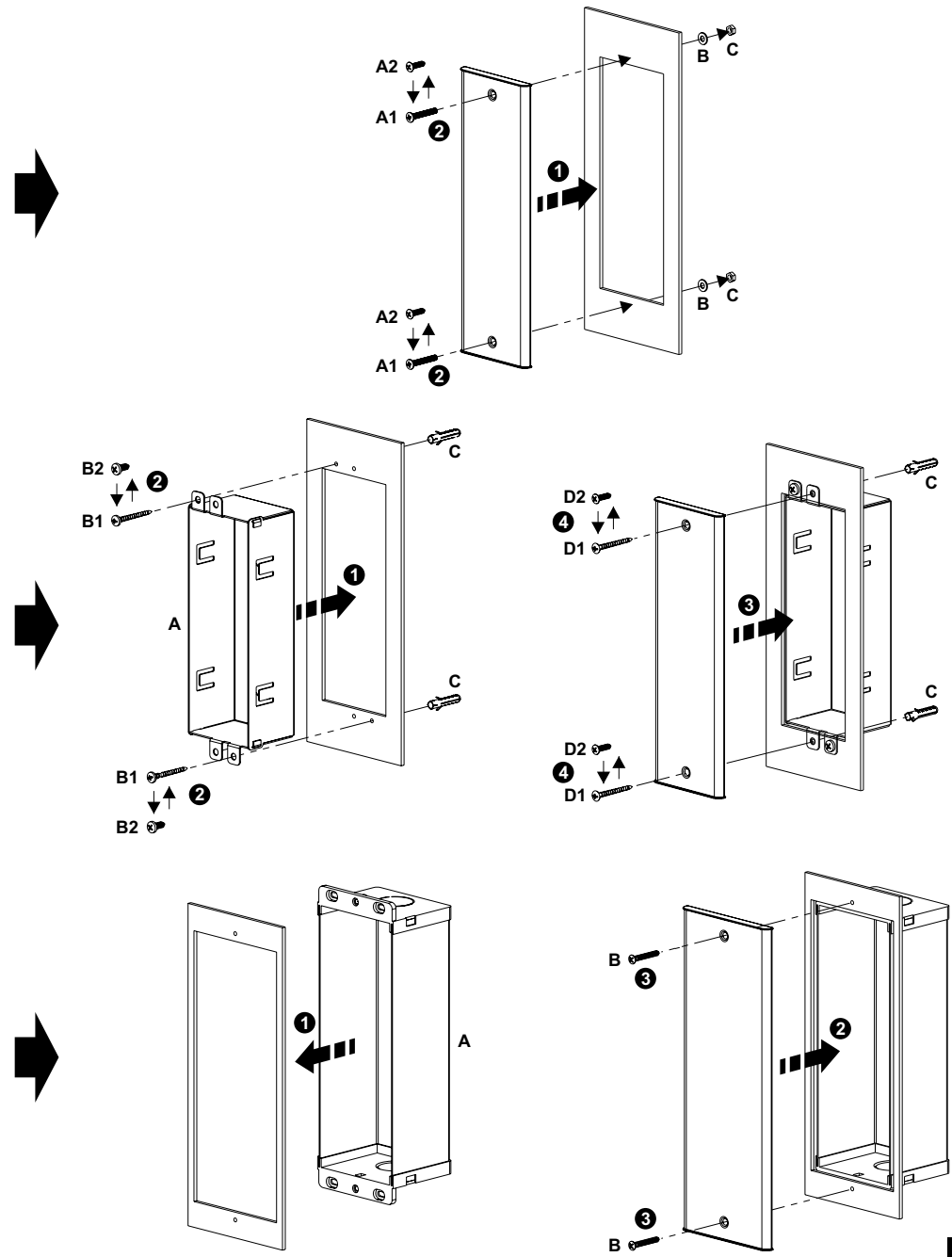
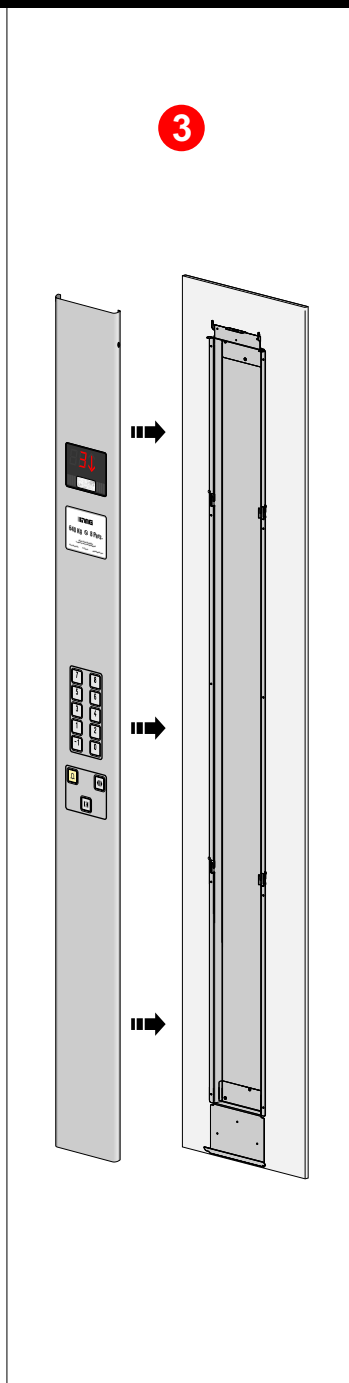
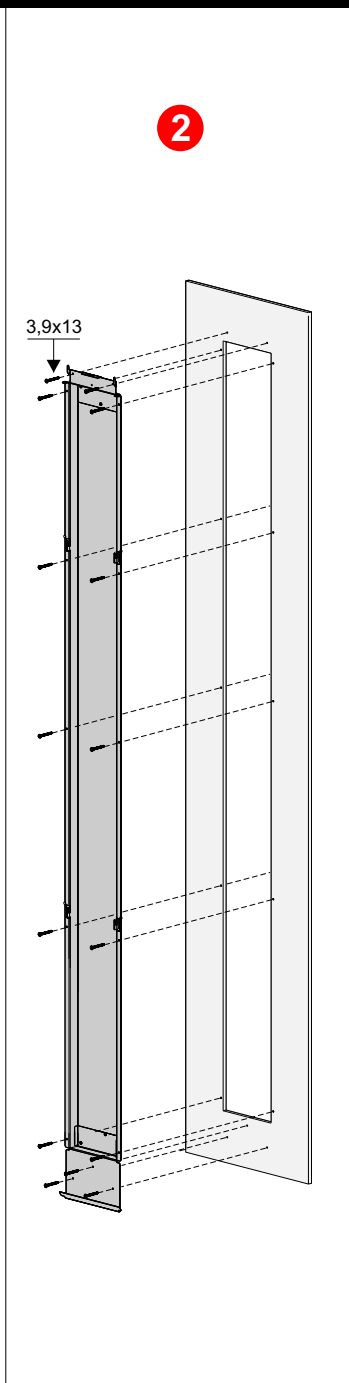
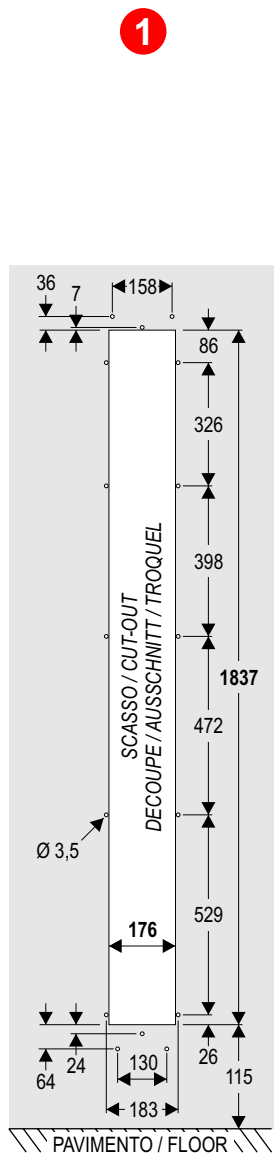

2) LOP-LIP FISSAGGIO NASCOSTO / HIDDEN LOCK FIXING

2.1) KIT DI FISSAGGIO E SCASSI / FIXING KIT AND CUT-OUT

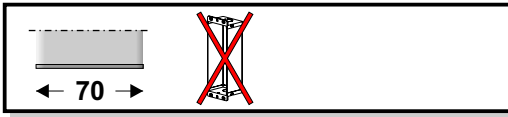

- 3,9x22 — A1 *Fissaggio su stipite / Door frame fixing / Fixation sur montant de porte / Befestigung auf Türzarge / Fijación en la jamba*
- 4x40 — A2 *Fissaggio a muro / Concrete wall fixing / Fixation au mur / Befestigung an der Mauer / Fijación el la pared*
- Ø 6 — B
- C
- D
- E
- 3,9x13 — F

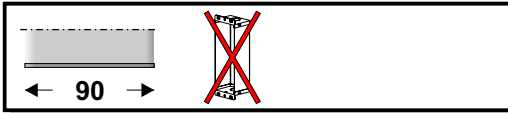
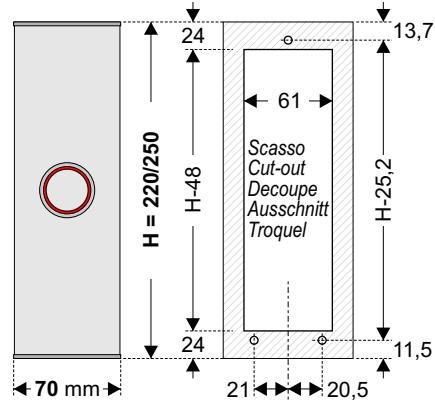

- 3,9x22 — A1 *Fissaggio su stipite / Door frame fixing / Fixation sur montant de porte / Befestigung auf Türzarge / Fijación en la jamba*
- 4x40 — A2 *Fissaggio a muro / Concrete wall fixing / Fixation au mur / Befestigung an der Mauer / Fijación el la pared*
- Ø 6 — B
- C
- D
- E
- 3,9x13 — F

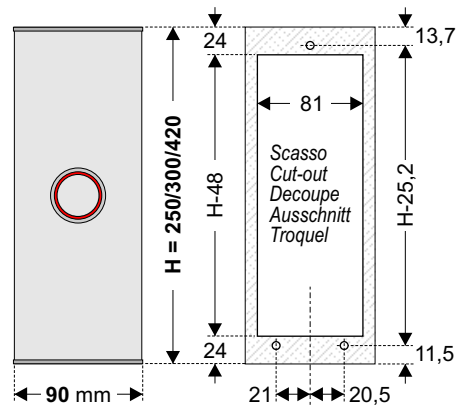

2.6) FISSAGGIO A MURO SENZA SCATOLA / CONCRETE WALL FIXING WITHOUT BOX

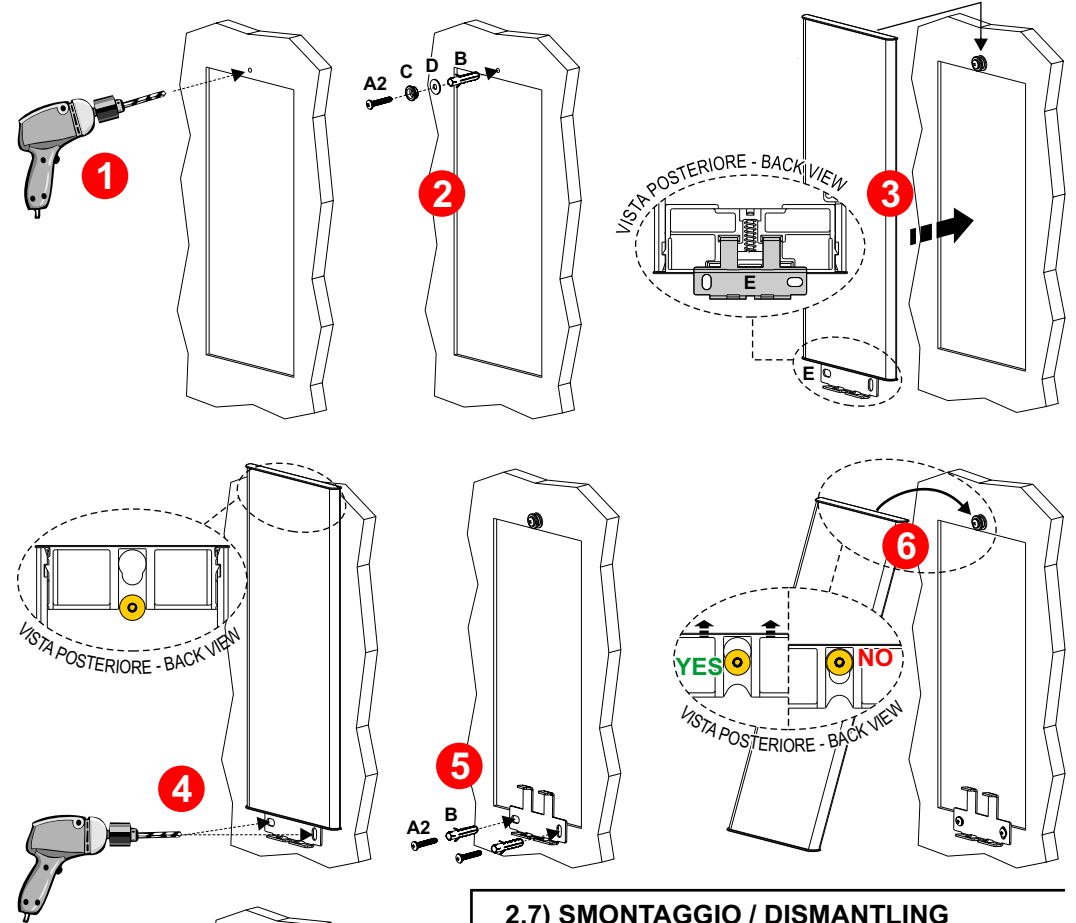

2.7) SMONTAGGIO / DISMANTLING

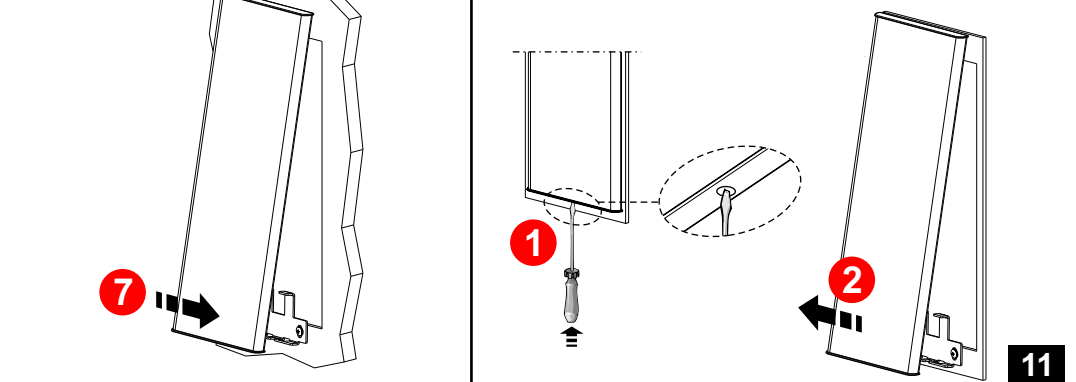

2.5) FISSAGGIO SU STIPITE SENZA SCATOLA / DOOR FRAME FIXING WITHOUT BOX

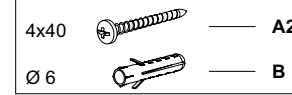
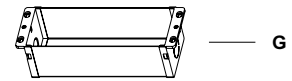
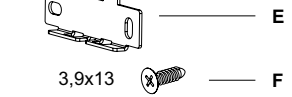
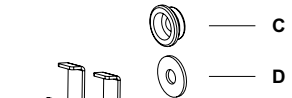
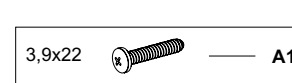
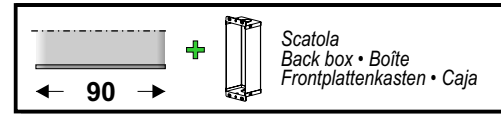
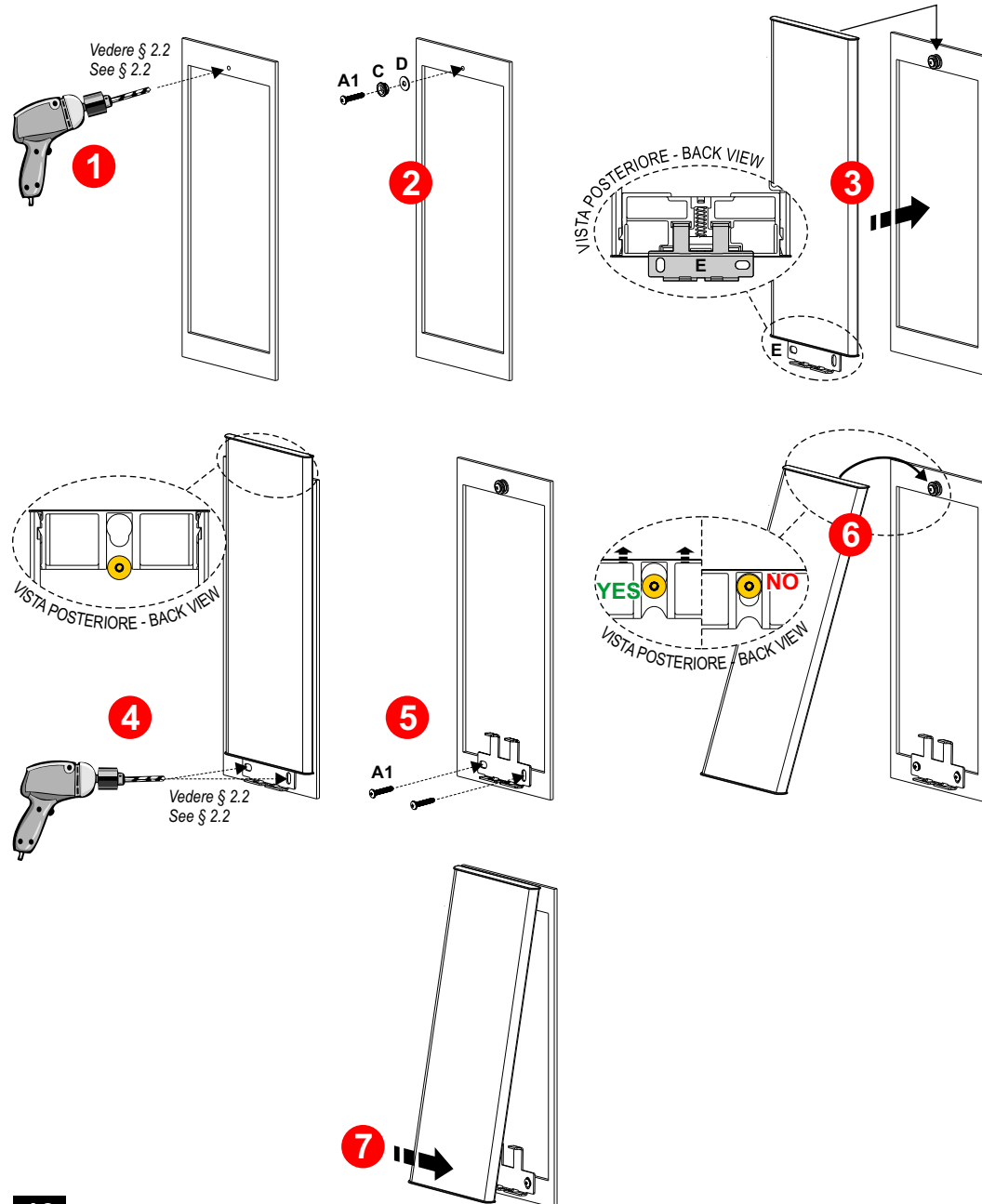

Fissaggio su stipite
Door frame fixing
Fixation sur montant de porte
Befestigung auf Türzarge
Fijación en la jamba

Fissaggio a muro
Concrete wall fixing
Fixation au mur
Befestigung an der Mauer
Fijación en la pared

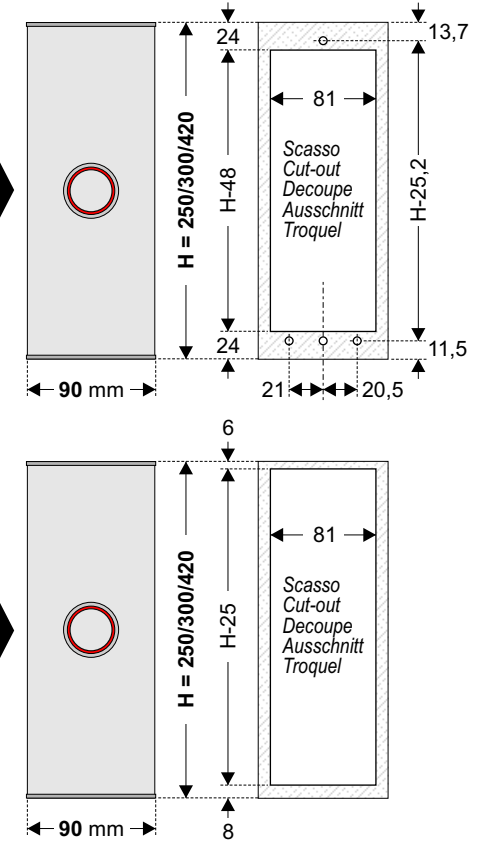

2.2) TABELLA DI RIFERIMENTO FORI / TABLE OF REFERENCE HOLES

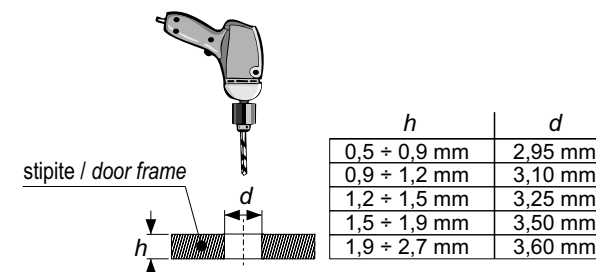

h	d
0,5 + 0,9 mm	2,95 mm
0,9 + 1,2 mm	3,10 mm
1,2 + 1,5 mm	3,25 mm
1,5 + 1,9 mm	3,50 mm
1,9 + 2,7 mm	3,60 mm

2.3) FISSAGGIO SU STIPITE CON SCATOLA / DOOR FRAME FIXING WITH BOX

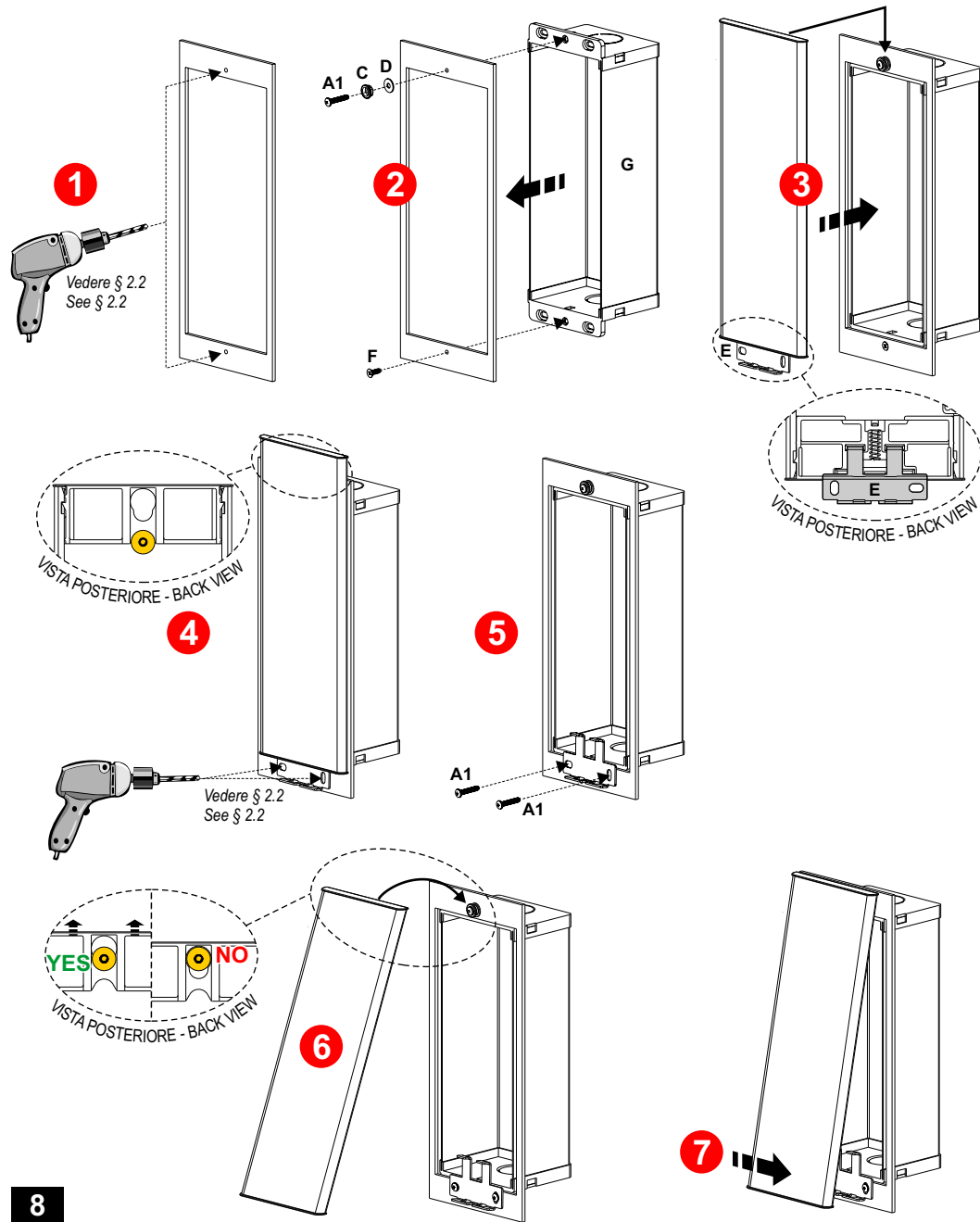

2.4) FISSAGGIO A MURO CON SCATOLA / CONCRETE WALL FIXING WITH BOX

